



## CONFERENCE & BANQUETING INFORMATION SHEET

### GENERAL LODGE INFORMATION

#### Shuttle service around resort and surrounding:

To/from local shopping centre	± 5min shuttle (1km)
To/from KMIA Airport	± 40min shuttle (40km)

### AMENITIES AND SERVICES

- Baby-sitting on request
- Camping cots available on request
- Postage & faxing
- Covered parking
- Safety deposit boxes
- Medical services on call
- Unlimited free internet access

### ACCOMODATION

#### 194 Chalets

Units range from 1 to 4 bedroom luxury self-catering chalets, either next to the tranquility of the Sabie River, or overlooking the Gary Player Golf course. These chalets can accommodate double, single and twin room bookings.

### RESORT FACILITIES

- Lapa on the bank of the Sabie River
- Outdoor chess
- 9-hole golf course with 18 tees
- Mini golf (9 holes)
- 4 Tennis courts (2 floodlit)
- Children's jungle gym
- 3 swimming pools
- Pool table
- Volleyball
- Darts
- 2 trampolines
- Golf driving range
- Hippo Hide
- Nature walk
- Hornbill golf shop
- Table tennis

### BANQUETING AND CONFERENCE

#### Guinea Fowl Room

Cinema	40 delegates
Schoolroom	30 delegates
U-Shape	30 delegates

### CONFERENCE AIDS AND FACILITIES

- Overhead projector
- Flipcharts
- Television, VCR & DVD
- Whiteboards
- Wall projector screen
- Data projector

### OUTDOORS AND SIGHTSEEING HIGHLIGHTS

- Hot air ballooning
- Cheetah and White Lion Project
- Blyde mountain bike rail
- River rafting
- Game drives
- Quad bike trails
- Helicopter flips
- Horse trails
- Abseiling
- Fishing

#### Panorama Tour

This tour covers the whole of the Mpumalanga Escarpment. Places to visit include Pilgrim's Rest, Sabie, Graskop, Mac Mac Falls, God's Window, Bourkes Luck Potholes and Lone Creek Falls. The rate includes lunch at either Harry's Pancakes in Graskop or the "Fig Tree" in Sabie.

#### Shangana Cultural Village

For an evening festival which includes tribal dancing, traditional snacks and a meal served in traditional huts.

Activities are subject to change and depend on the number of people booked. River rafting is seasonal and may change due to weather conditions.

### RESTAURANT

Restaurant – total capacity 120 pax

Breakfast	07h00 - 11h00	à la carte/Buffer
Lunch	11h00 - 18h00	à la carte
Dinner	19h00 - 22h00	à la carte/Buffer

#### Golf Patio and Lapa

For those wishing to enjoy peace and tranquility, there is a lapa on the river, as well as a golf patio.

### GAME DRIVES

Enjoy night or day game drives in the comfort of open air vehicles accompanied by experienced field guides. Kruger National Park is a mere 13km from Kruger Park Lodge.



**LEGACY**  
HOTELS & RESORTS

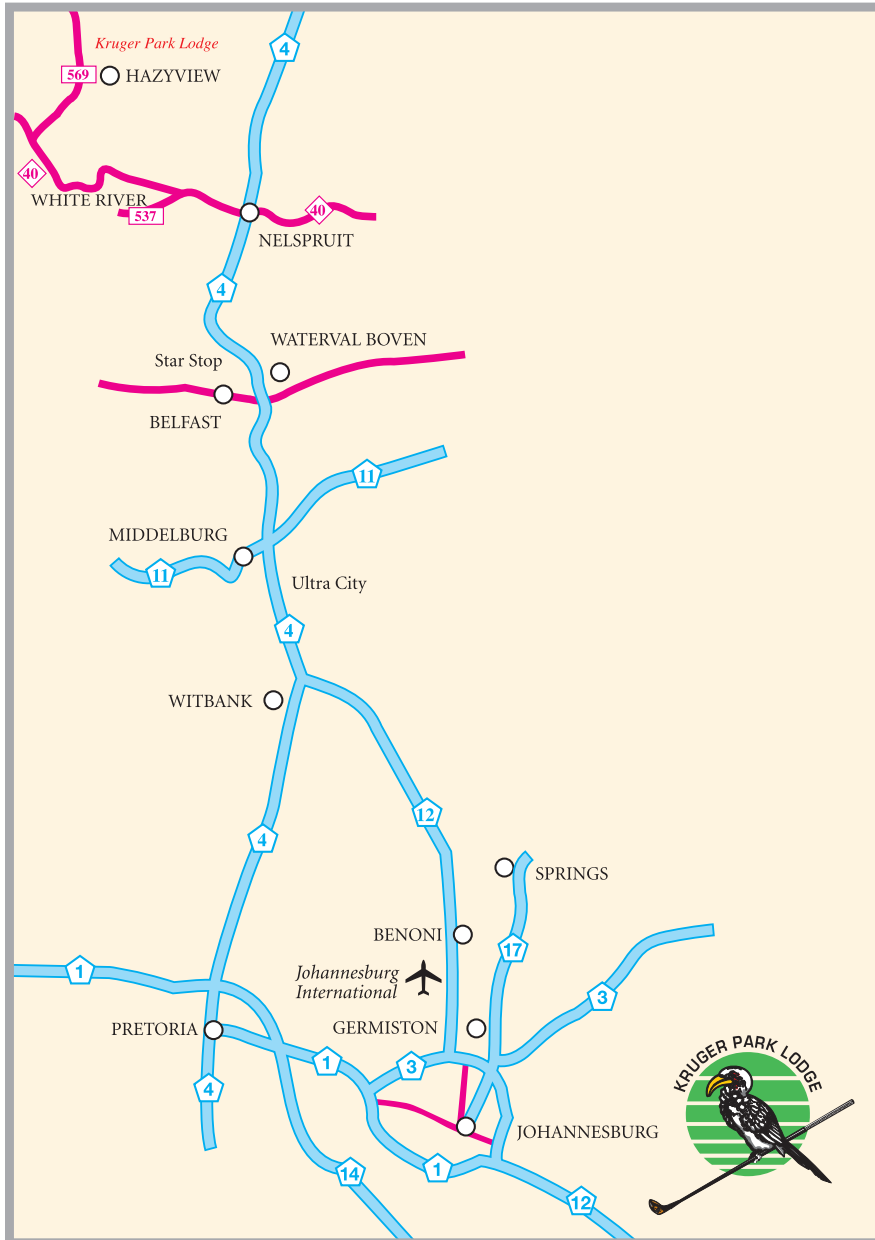

#### DIRECTIONS FROM O.R. TAMBO INTERNATIONAL AIRPORT TO THE KRUGER PARK LODGE

- Take the N4 to Witbank then follow through to Nelspruit
- In Nelspruit turn left at the THIRD traffic light and follow the signs to White River (R40, 20 kms)
- From White River follow signs to Hazyview (R40, 40kms)
- Kruger Park Lodge is 800 metres along the main Paul Kruger Gate Rd on the left hand side

#### GUINEA FOWL CONFERENCE ROOM

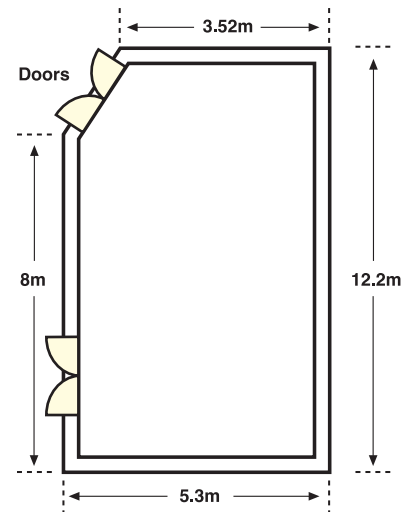

**KRUGER PARK LODGE**  
 Kruger Park Road, Hazyview · PO Box 989, Hazyview, 1242  
 Tel: +27 (0) 13 737 5000 · Fax: +27 (0) 13 737 7386  
 Email: [kruger@legacyhotels.com](mailto:kruger@legacyhotels.com) · Website: [www.legacyhotels.com](http://www.legacyhotels.com)  
 Central Reservations Tel: +27 (0) 11 806 6888 · Fax: +27 (0) 11 806 6899  
 Email: [hotels@legacyhotels.com](mailto:hotels@legacyhotels.com)

